

Approved by CC:

MAY 28 2013

REQUEST FOR AGENDA PLACEMENT FORM

Submission Deadline - Tuesday, 12:00 PM before Court Dates

SUBMITTED BY: Erik Dumas

TODAY'S DATE: 5/15/2013

DEPARTMENT:

X Public Works

SIGNATURE OF DEPARTMENT HEAD:

X

REQUESTED AGENDA DATE:

X May 28, 2013

SPECIFIC AGENDA WORDING: Consideration to grant a variance to construct a septic system on less than 1 acre, Lot 7 Block 3 in Green Valley Addition located in Precinct 3.

PERSON(S) TO PRESENT ITEM: Erik Dumas

SUPPORT MATERIAL: (Must enclose supporting documentation)

TIME: Ten Minutes

ACTION ITEM: X

WORKSHOP: _____

(Anticipated number of minutes needed to discuss item) CONSENT: _____

EXECUTIVE: _____

STAFF NOTICE:

COUNTY ATTORNEY: _____

ISS DEPARTMENT: _____

AUDITOR: _____

PURCHASING DEPARTMENT: _____

PERSONNEL: _____

PUBLIC WORKS: _____

BUDGET COORDINATOR: _____

OTHER: _____

*******This Section to be Completed by County Judge's Office*******

ASSIGNED AGENDA DATE: _____

REQUEST RECEIVED BY COUNTY JUDGE'S OFFICE _____

COURT MEMBER APPROVAL _____ Date _____



Variance Request for Septic System

Johnson County Subdivision Rules and Regulations state only one septic system per one (1) acre, Section VII A. To request a variance for the purpose of:

_____ installing a septic system on a lot or tract of less than an acre or

_____ two residences on one (1) septic system or

X installing a second septic system on a lot less than 2 acres

Please provide the following information. This request will be presented to the Commissioner's Court for their decision.

Owner Keith Shelley Date 5-15-13

Contact Information: Phone no. _____

Cell no 817-829-5918 Email address _____

Property Information for Variance Request:

Property 911 address 835 W. GREEN VALLEY CIRCLE
BURLESON, TN 36008

Subdivision name GREEN Valley Addition Block 3 Lot 7

Lot size: 1.26 acres Size of existing residence: 1250 sq. ft.

Does this lot currently have a septic system? Yes No System type Conventional

ETJ: Yes - City BURLESON No

Is a part of the property located in a FEMA designated Floodplain? Yes No

Reason for request TO put second septic system on Lot

Provide the following with this request:

- Copy of your plat if property has been platted
- Copy of property deed
- Survey or drawing showing existing home, buildings, existing & proposed septic system locations

JOHNSON COUNTY - SITE EVALUATION REPORT

Date 5-14-13
 Name Keith Shelley Phone 817-829-5918
 Address P.O. Box 56 - Bartlett, TX 76097
 PROPERTY LOCATION
 Lot 7 Block 3 Subdivision GREEN VALLEY Addition
 Street/Road Address _____
 Additional Information _____

SCHMATIC OF LOT OR TRACT

Compass North, adjacent street(s), direction of slope, property lines.
 Location of natural, constructed or proposed drainage ways, water impoundment areas, cut or fill banks, sharp slopes and buildings.
 Location of existing or proposed water wells.
 Location of (numbered) soil boring and dug pits (show distance of each hole from property line or other discernible point).

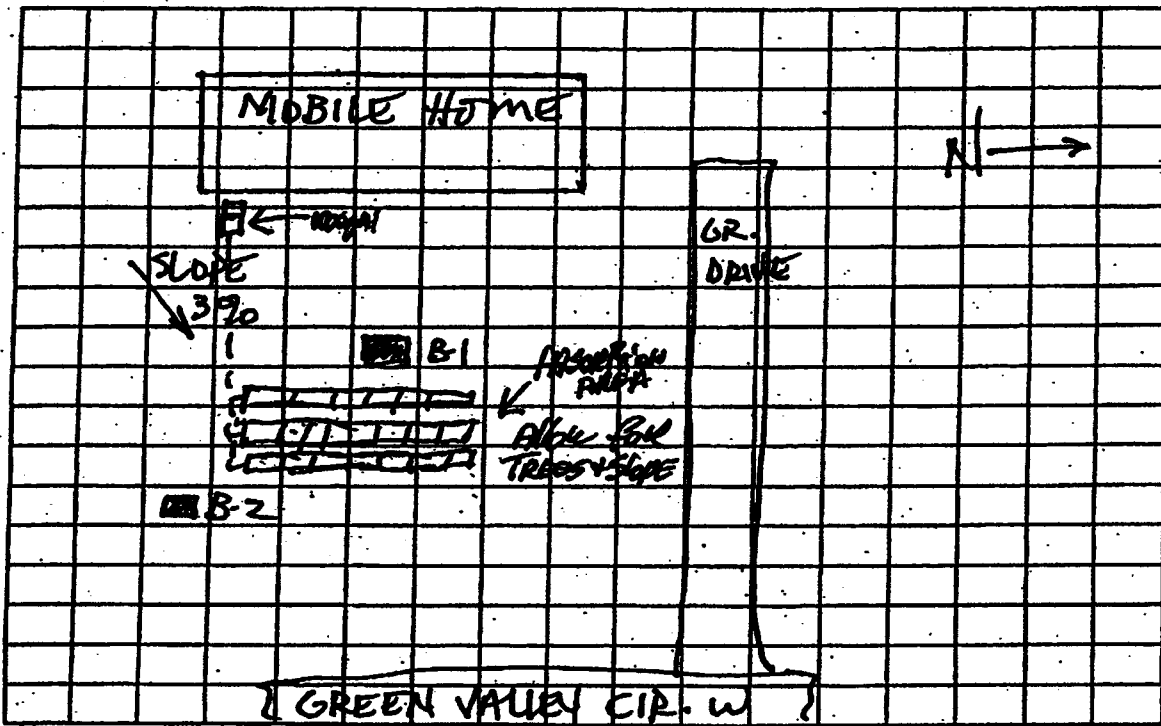

Presence of 100 year flood zone	Yes _____	No <input checked="" type="checkbox"/>	Firm Panel # _____
Presence of upper water shed	Yes <input checked="" type="checkbox"/>	No _____	
Presence of adjacent ponds, streams, water impoundment area	Yes _____	No <input checked="" type="checkbox"/>	
Existing or proposed water well in nearby area	Yes _____	No <input checked="" type="checkbox"/>	

ATTESTED BY:
 Signature K. Shelley

Site Evaluator No. 050028715

6395 RENDON NEW HOPE, FT WORTH TX 76140

8175976041

Address

Phone

The information on this report is required by Johnson County. The design, construction and installation of each system is based upon specific conditions affecting each lot or tract and must be subsequently approved by Johnson County.

